

RoHS Compliant

8

7

6

5

4

3

2

1

REV.	ECN NO.	DESCRIPTION	REVISER	DATE

1. 27mm(.050") CARD EDGE SLOT 90°

MATERIAL

Insulator: Glass-reinforced thermoplastic

Color: Black

Contact: Copper alloy

Plating: Mating Area- Selected Gold over Nickel

Solder Area- Tin over Nickel

SPECIFICATIONS

Temperature range: -55°C ~ +85°C

Current rating: 1.0A

Voltage rating: 250V AC

Dielectric withstand voltage: 500V AC

Insulation resistance: 1000 MΩ Min.

Contact resistance: 0.03Ω Max.

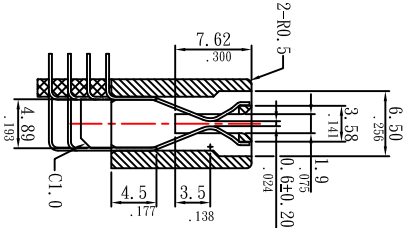

SECTION A-A

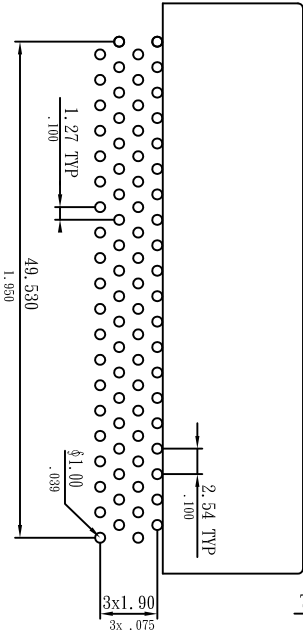
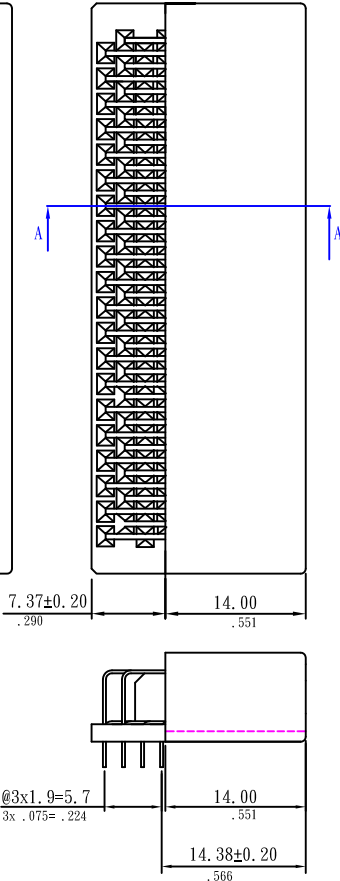
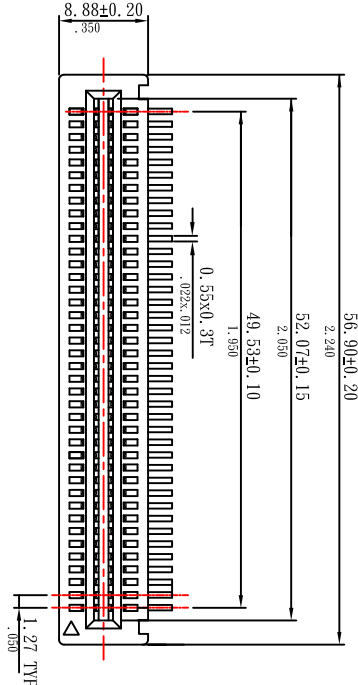

RECOMMENDED PCB LAYOUT (TOP VIEW)

TOLERANCE:±0.05

Order Information
SLT6830-080 H R-0 0-A
1 2 3 4 5 6 7

- 1.Series No.
- 2.80P
- 3.Selective gold plated
- 4.Right angle
- 5.Without ear
- 6.Without post
- 7.A=BLACK

	THIRD ANGLE PROJECTION	DRAWN BY:	ROY		
		CHECKED BY:	AP XU		
ALL DIMENSIONS ARE IN MM		APPROVED BY:	RICHAR	TITLE: 1. 27mm (.050") CARD EDGE SLOT 90°	
TOLERANCE UNSPECIFIED		DATE:	07/17/2016		
X .±0.35		SHEET:	1 OF 1	PART NUMBER: SLT6830-080 HR-00-A	
XXX ±0.15		SCALE:	FIT		
XXXX ±0.05		REV:	A0		
X° ±2°		SIZE:	A4		
XX° ±1°					



深圳市多维鑫电子有限公司
SHENZHEN TORVENICS ELECTRONIC CO.,LTD.